

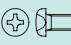



# 1. MACHINE SCREWS

	<b>CROSS RECESS PAN HEAD MACHINE SCREW</b>	Steel / Zinc 3Cr. Plated , Steel / Zinc Black 3Cr. Plated , Stainless Steel A2 , SUS 316L (Stainless Steel A4) Titan , VACUUM SCREWS	P.2~
	<b>CROSS RECESS FLAT HEAD MACHINE SCREW</b>	Steel / Zinc 3Cr. Plated , Steel / Zinc Black 3Cr. Plated , Stainless Steel A2 , SUS 316L (Stainless Steel A4) Titan , VACUUM SCREWS	P.6~
	<b>CROSS RECESS OVAL HEAD MACHINE SCREW</b>	Steel / Zinc 3Cr. Plated , Steel / Zinc Black 3Cr. Plated , Stainless Steel A2	P.10~
	<b>CROSS RECESS BINDING HEAD MACHINE SCREW</b>	Steel / Zinc 3Cr. Plated , Steel / Zinc Black 3Cr. Plated , Stainless Steel A2	P.12~
	<b>CROSS RECESS TRUSS HEAD MACHINE SCREW</b>	Steel / Zinc 3Cr. Plated , Steel / Zinc Black 3Cr. Plated , Stainless Steel A2 , SUS 316L (Stainless Steel A4)	P.14~

# CROSS RECESS PAN HEAD MACHINE SCREW JIS B1111 appendix

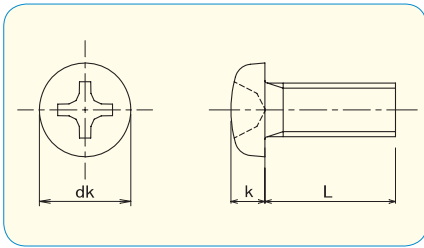

- Material · plating  
Steel / Zinc 3Cr. Plated  
Steel / Zinc Black 3Cr. Plated



RoHS Directive Compliance



	M2	M2.3	M2.5	M2.6	M3	M3.5	M4	M5	M6	M8	M10	
dk	3.5	4	4.5	4.5	5.5	6	7	9	10.5	14	19	
k	1.3	1.5	1.7	1.7	2	2.3	2.6	3.3	3.9	5.2	6	
Drive Size	1				2				3		4	

pcs / Box											
L \ d	M2	M2.3	M2.5	M2.6	M3	M3.5	M4	M5	M6	M8	M10
3	12,000	8,000	5,000	5,000	3,000		2,800				
4	10,000	7,000	5,000	5,000	3,000	4,000	2,500	1,000			
5	8,000	6,000	5,000	5,000	3,000	4,000	2,500	1,000			
6	8,000	6,000	4,500	4,500	2,500	3,500	2,200	1,000	600		
8	6,000	5,000	3,500	3,500	2,200	2,500	2,000	1,000	600	350	
10	5,000	4,000	3,000	3,000	2,000	2,500	1,600	900	600	300	
12	4,000	2,500	2,500	2,500	2,500	2,000	1,500	800	600	300	
14	3,000	2,200	2,000	2,000	2,200	1,600	1,200	800	500	250	
15	3,000	2,200	1,800	2,000	2,000	1,600	1,200	700	500	250	
16	2,500	2,200	1,800	1,800	2,000	1,600	1,000	700	450	250	200
18	2,200	2,000	1,500	1,500	1,600	1,200	1,000	600	400	200	
20	2,000	1,500	1,500	1,500	1,500	1,200	900	500	350	200	180
22	1,500			1,000	1,400	1,000	800	700		250	
25	1,500	1,000	1,000	1,000	1,200	1,000	700	700	500	220	150
30	1,000	800	800	800	1,000	800	600	600	400	200	130
35	1,000		500	500	700	600	500	500	300	180	120
40	700		500	500	600	800	600	400	300	160	100
45			500	500	800	600	500	350	250	150	80
50			500	500	600	500	450	300	200	130	80
55					600		400	250	200	120	80
60				* 500	500		300	230	180	100	70
65					500		300	200	150	100	70
70					800		300	200	120	90	60
75					700		300	200	200	90	60
80					* 500		300	200	200	90	50
85					* 500		300	300	180	* 80	50
90					* 500		400	250	170	80	50
95					* 400		400	250	170	* 80	50
100					* 400		400	250	150	80	50
105					* 500		* 400	* 250	150	* 80	
110					* 500		* 350	* 220	150	* 80	
115					* 500		* 350	* 200	130	* 80	
120					* 500		* 350	* 200	130	* 80	
125					* 500		* 350	* 200	120	* 80	
130					* 600		* 350	* 200	120	* 80	
135					* 600		* 350	* 200	150	* 80	
140					* 600		* 350	* 200	150	* 80	
145					* 600		* 350	* 200	150	* 80	
150					* 600		* 350	* 200	150	* 80	
160					* 600		* 300	* 200	* 150		
170					* 600		* 300	* 200	* 150		
180					* 600		* 300	* 200	* 150		
190					* 600		* 300	* 200	* 150		
200					* 600		* 300	* 200	* 150		

\* ... Zinc 3Cr. Plated only

# CROSS RECESS PAN HEAD MACHINE SCREW JIS B1111 appendix

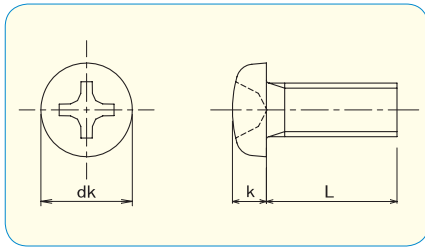

●Material  
Stainless Steel A2



RoHS Directive Compliance



	M2	M2.3	M2.5	M2.6	M3	M4	M5	M6	M8	M10
dk	3.5	4	4.5	4.5	5.5	7	9	10.5	14	19
k	1.3	1.5	1.7	1.7	2	2.6	3.3	3.9	5.2	6
Drive Size	1			2			3		4	

		pcs / Box									
d	L	M2	M2.3	M2.5	M2.6	M3	M4	M5	M6	M8	M10
3	3	10,000	10,000	8,000	8,000	4,000					
4	4	10,000	10,000	8,000	8,000	2,000	2,000				
5	5	10,000	6,000	6,000	6,000	2,000	1,000				
6	6	10,000	8,000	6,000	6,000	2,000	1,000	1,000	500		
8	8	8,000	6,000	5,000	4,000	2,000	1,000	1,000	500		
10	10	6,000	6,000	4,000	4,000	2,000	1,000	500	500	200	
12	12	6,000	4,000	3,000	3,000	2,000	1,000	500	500	200	
14	14	4,000	4,000	3,000	3,000	2,000	1,000	500	500	200	
15	15	4,000	3,000	2,500	2,000	1,000	1,000	500	500	200	
16	16	4,000		2,000	2,000	1,000	1,000	500	200	100	100
18	18	3,000			2,000	1,000	500	500	200	100	
20	20	3,000	2,000	2,000	2,000	1,000	500	500	200	100	100
22	22						500	500	200		
25	25	2,000	1,000	1,500	1,000	1,000	500	400	200	100	50
30	30	1,000	1,000	1,000	1,000	500	500	200	200	100	50
35	35					500	500	200	200	100	50
40	40					500	200	200	100	50	50
45	45					500	200	200	100	50	50
50	50					500	200	100	100	50	50
55	55						200	100	100	50	50
60	60						200	100	100	50	50
65	65						200	100	100	50	50
70	70						200	100	100	50	50
75	75						200	100	100	50	50
80	80						200	100	100	50	50
90	90						200	100	50	50	50
100	100						200	100	50	50	50

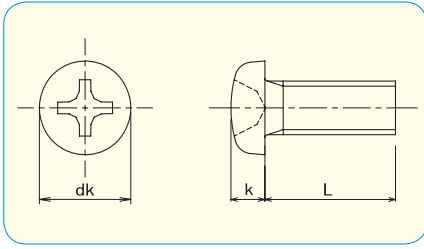
**SUS 316L****TITAN****MACHINE  
SCREWS****CROSS RECESS PAN HEAD MACHINE SCREW JIS B1111 appendix**

RoHS Directive Compliance

	M3	M4	M5	M6	M8
dk	5.5	7	9	10.5	14
k	2	2.6	3.3	3.9	5.2
Drive Size	2			3	

● **Material****SUS 316L** Stainless Steel A4

pcs / Box

L \ d	M3	M4	M5	M6	M8
5	500				
6	500	300	200		
8	500	300	200		
10	500	300	200	100	
12	500	300	200	100	50
15	500	300	200	100	50
16	500	300	200	100	50
20	500	300	200	100	50
25	500	300	200	100	50
30	500	300	200	100	50
35		300	200	100	50
40	500	300	200	100	50
45		300	200	100	50
50		300	200	100	50
55		300	200	100	50
60		300	200	100	50
65		300	200	100	50
70			200	100	50
75			200	100	50
80				100	50
90				100	50
100				100	50

● **Material****TITAN**

pcs / Box

L \ d	M3	M4	M5	M6
6	500	300		
8	500	300	200	
10	500	300	200	100
12	500	300	200	100
15	500	300	200	100
16	500	300	200	100
20	500	300	200	100
25	500	300	200	100
30	500	300	200	100
35		300	200	100
40		300	200	100
45			200	100
50			200	100
60				100

# VACUUM SCREWS CROSS RECESS PAN HEAD MACHINE SCREW

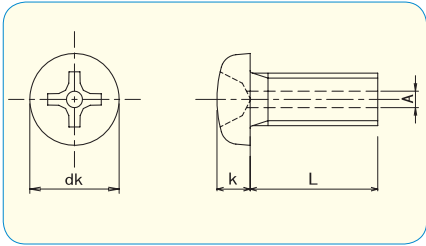

- **Material · plating**  
Stainless Steel A2  
Stainless Steel A2 , Special Chemical Polish



	M3	M4	M5	M6
dk	5.5	7	9	10.5
k	2	2.6	3.3	3.9
A	1.2	1.5	1.5	2
Drive Size	2			3



- **Material**  
Stainless Steel A2

		pcs / Box			
L \ d	M3	M4	M5	M6	
5	20	20			
6	20	20	10		
8	20	20	10	10	
10	20	20	10	10	
12	20	20	10	10	
16		20	10	10	
20			10	10	
25				10	

- **Material**  
Stainless Steel A2 , Special Chemical Polish

		pcs / Box			
L \ d	M3	M4	M5	M6	
5	20	20			
6	20	20	10		
8	20	20	10	10	
10	20	20	10	10	
12	20	20	10	10	
16		20	10	10	
20			10	10	
25				10	

# CROSS RECESS FLAT HEAD MACHINE SCREW JIS B1111 appendix

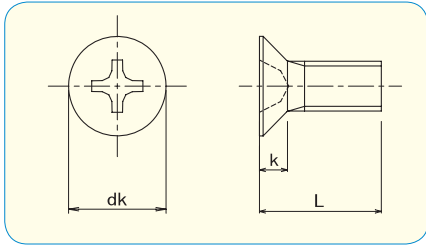

- Material · plating  
Steel / Zinc 3Cr. Plated  
Steel / Zinc Black 3Cr. Plated



	M2	M2.3	M2.5	M2.6	M3	M3.5	M4	M5	M6	M8	M10	
dk	4	4.6	5	5.2	6	7	8	10	12	16	20	
k	1.2	1.35	1.45	1.5	1.75	2	2.3	2.8	3.4	4.4	5.7	
Drive Size	1				2				3		4	

												pcs / Box
d L	M2	M2.3	M2.5	M2.6	M3	M3.5	M4	M5	M6	M8	M10	
3	13,000	8,000	8,000	8,000								
4	12,000	8,000	6,000	6,000	4,000							
5	10,000	7,000	6,000	6,000	4,000	4,000	3,000					
6	9,000	6,000	5,000	5,000	3,500	4,000	2,500	1,200				
8	7,000	5,000	4,000	4,000	2,500	3,000	2,000	1,200	800			
10	5,000	4,000	3,000	3,000	2,200	2,500	1,800	1,100	700	300		
12	4,000	2,500	2,500	2,500	2,500	2,000	1,500	1,000	600	300		
14	3,500	2,200	2,000	2,000	2,500		1,200	800	600	250		
15	3,000	2,200	1,800	2,000	2,000		1,200	700	500	250		
16	2,500	2,000	1,800	1,800	2,000	1,600	1,200	700	500	250	250	
18	2,500	2,000	1,500	1,600	1,800		1,000	600	450	200		
20	2,000	1,500	1,500	1,500	1,500	1,200	900	600	400	200	200	
22	1,500				1,400		900	800	500	250		
25		1,000		1,000	1,200		700	700	500	220	180	
30				800	1,000		600	600	400	200	150	
35					700		500	500	300	180	120	
40					600		600	400	300	160	100	
45					800			350	250	150	100	
50					600		450	300	200	130	80	
55					600		400	250	200	120	80	
60					500		300	230	180	100	70	
65					500		300	200	150	100	70	
70					800		300	200	120	90	60	
75							300	200	200	90	60	
80							300	200	200	90	50	
85											50	
90							400	250	170	80	50	
95											50	
100							400		150	80	50	

\* ... Zinc 3Cr. Plated only

# CROSS RECESS FLAT HEAD MACHINE SCREW JIS B1111 appendix

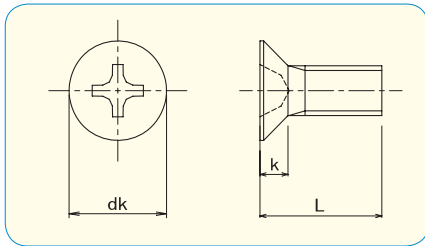

●Material  
Stainless Steel A2



	M2	M2.3	M2.5	M2.6	M3	M4	M5	M6	M8	M10
dk	4	4.6	5	5.2	6	8	10	12	16	20
k	1.2	1.35	1.45	1.5	1.75	2.3	2.8	3.4	4.4	5.7
Drive Size	1			2			3		4	

L	d	pcs / Box									
		M2	M2.3	M2.5	M2.6	M3	M4	M5	M6	M8	M10
3		10,000									
4		10,000	10,000	8,000	8,000	3,000					
5		10,000	8,000	6,000	6,000	2,000	2,000				
6		10,000	8,000	6,000	6,000	2,000	1,000	1,000			
8		8,000	6,000	5,000	4,000	2,000	1,000	1,000	500		
10		6,000	6,000	4,000	4,000	2,000	1,000	1,000	500		
12		6,000	4,000	3,000	3,000	2,000	1,000	500	500	200	
14		4,000	4,000	2,500	2,000	2,000	1,000	500	500	200	
15		4,000	3,000	2,500	2,000	1,000	1,000	500	500	200	
16		3,000	3,000	2,500	2,000	1,000	1,000	500	200	200	100
18		3,000	2,000	2,000	2,000	1,000	500	500	200	200	
20		3,000	2,000	2,000	2,000	1,000	500	500	200	100	100
22							500	500			
25		2,000	1,000	1,500	1,000	1,000	500	500	200	100	100
30		1,000	1,000	1,000	1,000	1,000	500	200	200	100	100
35						500	500	200	200	100	50
40						500	200	200	100	50	50
45						500	200	200	100	50	50
50						500	200	100	100	50	50
55							200	100	100	50	50
60							200	100	100	50	50
65							200	100	100	50	50
70							200	100	100	50	50
75							200	100	100	50	50
80							200	100	100	50	50
90							200	100	50	50	50
100							200	100	50	50	50

CROSS RECESS FLAT HEAD MACHINE SCREW JIS B1111 appendix

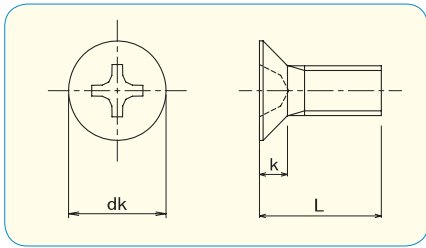

RoHS Directive Compliance

	M3	M4	M5	M6	M8
dk	6	8	10	12	16
k	1.75	2.3	2.8	3.4	4.4
Drive Size	2			3	



• Material

**SUS 316L** Stainless Steel A4

pcs / Box

L \ d	M3	M4	M5	M6	M8
5	500				
6	500	300			
8	500	300	200		
10	500	300	200	100	
12	500	300	200	100	
15	500	300	200	100	50
16	500	300	200	100	50
20	500	300	200	100	50
25	500	300	200	100	50
30	500	300	200	100	50
35		300	200	100	50
40	500	300	200	100	50
45		300	200	100	50
50		300	200	100	50
55		300	200	100	50
60		300	200	100	50
65		300	200	100	50
70			200	100	50
75			200	100	50
80				100	50
90				100	50
100				100	50



• Material

**TITAN**

pcs / Box

L \ d	M3	M4	M5	M6
6	500	300		
8	500	300	200	
10	500	300	200	100
12	500	300	200	100
15	500	300	200	100
16	500	300	200	100
20	500	300	200	100
25	500	300	200	100
30	500	300	200	100
35		300	200	100
40		300	200	100
45			200	100
50			200	100
60				100



# VACUUM SCREWS CROSS RECESS FLAT HEAD MACHINE SCREW

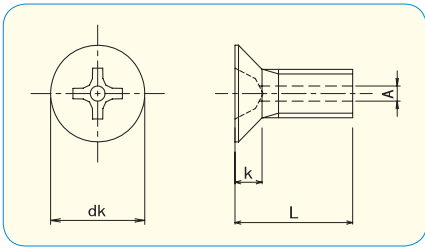

- **Material · plating**  
Stainless Steel A2  
Stainless Steel A2 , Special Chemical Polish



	M3	M4	M5	M6
dk	6	8	10	12
k	1.75	2.3	2.8	3.4
A	1.2	1.5	1.5	2
Drive Size	2			3



- **Material**  
Stainless Steel A2

		pcs / Box			
L \ d	M3	M4	M5	M6	
5	20	20			
6	20	20	10		
8	20	20	10	10	
10	20	20	10	10	
12	20	20	10	10	
16		20	10	10	
20			10	10	
25				10	

- **Material**  
Stainless Steel A2, Special chemical Polish

		pcs / Box			
L \ d	M3	M4	M5	M6	
5	20	20			
6	20	20	10		
8	20	20	10	10	
10	20	20	10	10	
12	20	20	10	10	
16		20	10	10	
20			10	10	
25				10	

# CROSS RECESS OVAL HEAD MACHINE SCREW JIS B1111 appendix

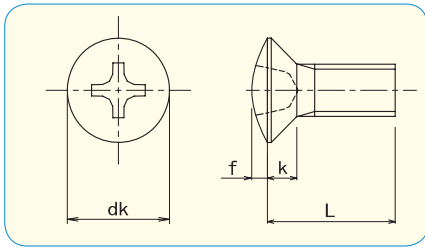

- Material · plating  
Steel / Zinc 3Cr. Plated  
Steel / Zinc Black 3Cr. Plated



RoHS Directive Compliance

	M2	M2.5	M2.6	M3	M3.5	M4	M5	M6	M8	
dk	4	5	5.2	6	7	8	10	12	16	
k	1.2	1.45	1.5	1.75	2	2.3	2.8	3.4	4.4	
f	0.4	0.55	0.6	0.7	0.8	0.9	1.2	1.4	1.8	
Drive Size	1			2				3		

L \ d	pcs / Box								
	M2	M2.5	M2.6	M3	M3.5	M4	M5	M6	M8
3	12,000								
4	10,000	5,000	5,000	4,000					
5	8,000	5,000	5,000	3,000	4,000				
6	8,000	4,500	4,500	2,500	4,000	2,200			
8	6,000	3,500	3,500	2,200	3,000	2,000	1,000	700	
10	5,000	3,000	3,000	2,000	2,500	1,600	900	600	
12			2,500	2,500	2,000	1,500	800	600	300
14			2,000	2,200		1,200	800	500	
15			1,800	2,000		1,200	700	500	250
16			1,800	2,000		1,000	700	450	250
18				1,600		1,000	600	400	200
20				1,500		900	500	350	200
22				1,400		800	700	500	
25				1,200		700	700	500	220
30				1,000		600	600	400	200
35				700		500	500	300	180
40				600		600	400	300	160
45				800		500	350	250	150
50				600		450	300	200	130

\* ... Zinc 3Cr. Plated only

# CROSS RECESS OVAL HEAD MACHINE SCREW JIS B1111 appendix

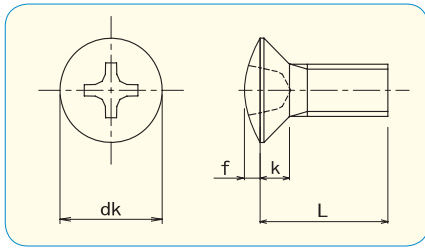

●Material  
Stainless Steel A2



	M3	M4	M5	M6
dk	6	8	10	12
k	1.75	2.3	2.8	3.4
f	0.7	0.9	1.2	1.4
Drive Size	2			3

		pcs / Box			
d	L	M3	M4	M5	M6
5	5	3,000			
6	6	3,000	2,000		
8	8	2,000	1,000	1,000	
10	10	2,000	1,000	500	500
12	12	2,000	1,000	500	500
14	14	2,000	500	500	500
15	15	1,000	500	500	500
16	16	1,000	1,000	500	200
18	18	1,000	500	500	200
20	20	1,000	500	500	200
22	22			500	
25	25	1,000	500	500	200
30	30	500	500	200	200
35	35		500	200	200
40	40		200	200	100
45	45		200	200	100
50	50		200	100	100

# CROSS RECESS BINDING HEAD MACHINE SCREW JIS B1111 appendix

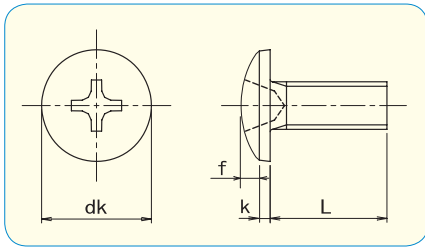

- Material · plating  
Steel / Zinc 3Cr. Plated  
Steel / Zinc Black 3Cr. Plated



	M2	M2.3	M2.5	M2.6	M3	M3.5	M4	M5	M6	M8
dk	4.3	4.9	5.3	5.5	6.3	7.3	8.3	10.3	12.4	16.4
k+f	1.2	1.4	1.5	1.6	1.9	2.2	2.5	3.1	3.7	4.8
Drive Size	1			2				3		

		pcs / Box								
L \ d	M2	M2.3	M2.5	M2.6	M3	M3.5	M4	M5	M6	M8
2	10,000									
3	10,000	6,000	5,000	4,000	2,500		2,000			
4	8,000	6,000	5,000	4,000	2,500		1,600			
5	7,000	5,000	4,000	4,000	2,500	2,500	1,600	800		
6	6,000	5,000	3,500	3,500	2,200	2,500	1,600	800	500	
8	5,000	4,000	3,000	3,000	1,800	2,000	1,500	800	500	250
10	4,000	3,000	2,500	2,500	1,800	1,800	1,200	800	450	250
12	3,500	2,000	2,000	2,000	2,200	1,600	1,200	700	400	200
14	2,500	2,000	1,800	1,800	2,000		1,000	600	400	150
15	2,500	2,000	1,500	1,500	1,800		1,000	600	350	150
16	2,200	1,800	1,500	1,500	1,800		900	500	350	150
18	2,000		1,500	1,500	1,500		800	500	300	150
20	1,800		1,200	1,200	1,400		700	450	300	150
22					1,200		700	500		
25					1,000		600	500	400	180
30					800		500	500	300	170
35					700		400	400	300	160
40					500		500	350	250	140
45					700		450	300	200	130
50					600		400	250	180	110
55							* 350			
60							* 300			

\* ... Zinc 3Cr. Plated only

# CROSS RECESS BINDING HEAD MACHINE SCREW JIS B1111 appendix

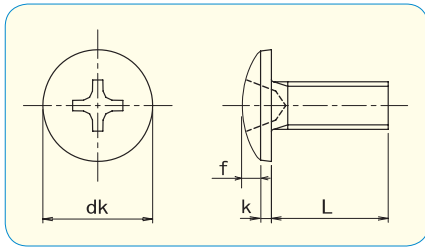

●Material  
Stainless Steel A2



	M3	M4	M5	M6
dk	6.3	8.3	10.3	12.4
k+f	1.9	2.5	3.1	3.7
Drive Size	2			3

L	pcs / Box			
	M3	M4	M5	M6
3	3,000			
4	3,000	1,000		
5	2,000	1,000		
6	2,000	1,000	500	
8	2,000	1,000	500	500
10	2,000	1,000	500	500
12	2,000	1,000	500	200
14	1,000	500	500	200
15	1,000	500	500	200
16	1,000	500	500	200
18	1,000	500	500	200
20	1,000	500	400	200
22				
25	500	500	200	200
30	500	500	200	200
35		200	200	100
40		200	200	100
45		200	100	100
50		200	100	100

# CROSS RECESS TRUSS HEAD MACHINE SCREW JIS B1111 appendix

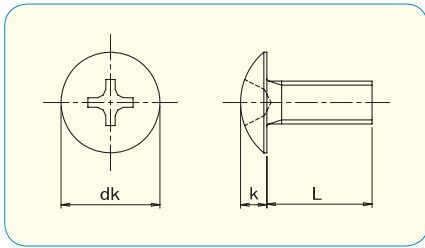

- Material · plating
  - Steel / Zinc 3Cr. Plated
  - Steel / Zinc Black 3Cr. Plated



RoHS Directive Compliance

	M2	M2.3	M2.5	M2.6	M3	M3.5	M4	M5	M6	M8	M10
dk	4.5	5.2	5.7	5.9	6.9	8.1	9.4	11.8	14	17.8	21
k	1.2	1.4	1.5	1.6	1.9	2.2	2.5	3.1	3.7	4.8	5.1
Drive Size	1					2			3		4

												pcs / Box
d L	M2	M2.3	M2.5	M2.6	M3	M3.5	M4	M5	M6	M8	M10	
2	10,000											
3	8,000	7,000	4,000	4,000	2,500		2,000					
4	8,000	6,000	4,000	4,000	2,500		1,600					
5	7,000	5,000	4,000	4,000	2,500	2,500	1,600	800				
6	6,000	5,000	3,500	3,500	2,200	2,500	1,600	800	500			
8	5,000	4,000	3,000	3,000	1,800	2,000	1,500	800	500	250		
10	4,000	3,000	2,500	2,500	1,800	1,800	1,200	800	450	250		
12	3,500	2,000	2,000	2,000	2,200	1,600	1,200	700	400	200		
14	2,500	2,000	1,800	1,800	2,000	1,400	1,000	600	400	150		
15	2,500	2,000	1,500	1,500	1,800	1,200	1,000	600	350	150		
16	2,200	1,800	1,500	1,500	1,800	1,200	900	500	350	150	150	
18	2,000		1,500	1,500	1,500		800	500	300	150		
20	1,800		1,200	1,200	1,400	1,000	700	450	300	150	150	
22					1,200		700	600	400	220		
25					1,000	800	600	500	400	180	100	
30					800	600	500	500	300	170	100	
35					700		400	400	300	160	100	
40					500		500	350	250	140	80	
45					700		450	300	200	130	80	
50					600		400	250	180	110	70	
55							350	200	150	100		
60							300	200	150	100		
65							250	180	120	90		
70							250	180	120	80		
75							250	180	160			
80									150	70		
85												
90								250	130	70		
95												
100									130	70		

\* ... Zinc 3Cr. Plated only

**CROSS RECESS TRUSS HEAD MACHINE SCREW JIS B1111 appendix**

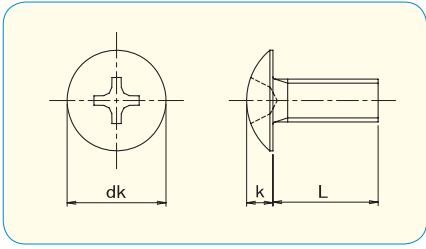

	M2.6	M3	M4	M5	M6	M8
dk	5.9	6.9	9.4	11.8	14	17.8
k	1.6	1.9	2.5	3.1	3.7	4.8
Drive Size	1		2		3	

●Material  
Stainless Steel A2

d		pcs / Box				
L	M2.6	M3	M4	M5	M6	M8
3	6,000	3,000				
4	6,000	3,000				
5	4,000	2,000	1,000			
6	4,000	2,000	1,000	500		
8	3,000	2,000	1,000	500	500	
10	3,000	2,000	1,000	500	500	200
12	3,000	2,000	1,000	500	200	200
14	2,000	1,000	500	500	200	200
15	2,000	1,000	500	500	200	200
16		1,000	500	500	200	200
18		1,000	500	500	200	100
20		1,000	500	400	200	100
22			500		200	
25		500	500	200	200	100
30		500	500	200	200	100
35			200	200	200	50
40			200	200	100	50
45			200	100	100	50
50			200	100	100	50



●Material  
**SUS 316L** Stainless Steel A4

L	M4	M5
6	300	
8	300	200
10	300	200
12	300	200
15	300	200
16	300	200
20	300	200
25	300	200
30	300	200

pcs / Box

