





10. RINGS / THREADED RODS

	Retaining Rings C Type	Stainless Steel A2	P.2
	Retaining Rings C Type	Stainless Steel A2	P.3
	Retaining Rings E Type	Steel / Zinc 3Cr. Plated , Stainless Steel A2	P.4
	Threaded Rods	Steel / Zinc 3Cr. Plated , Steel / Zinc Black 3Cr. Plated , Stainless Steel A2	P.5~
	Threaded Rods for Chemical Anchors	Stainless Steel A2	P.7

Retaining Rings-C Type JIS B 2804

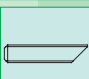
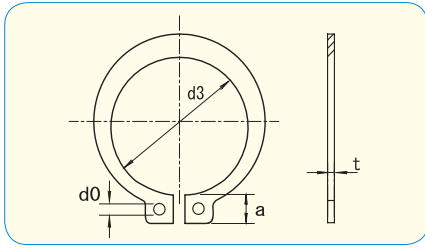

● Material
Stainless Steel A2



RoHS Directive Compliance



	Box q'ty	SIZE				pcs / Box
		d3	t	a	d0	
M3.2	2000	2.7	0.25	1.7	0.7	
M4	2000	3.7	0.4	2.2	0.8	
M5	2000	4.7	0.6	2.4	0.8	
M6	2000	5.6	0.7	2.8	1	
M7	2000	6.5	0.8	3	1	
M8	2000	7.4	0.8	3	1	
M9	2000	8.4	1	3.2	1	
M10	2000	9.3	1	3	1.2	
M11	2000	10.2	1	3.1	1.2	
M12	2000	11.1	1	3.2	1.5	
M13	2000	12	1	3.3	1.5	
M14	2000	12.9	1	3.4	1.7	
M15	2000	13.8	1	3.5	1.7	
M16	2000	14.7	1	3.6	1.7	
M17	2000	15.7	1	3.7	1.7	
M18	1000	16.5	1.2	3.8	1.7	
M19	1000	17.5	1.2	3.8	2	
M20	1000	18.5	1.2	3.9	2	
M21	1000	19.5	1.2	4	2	
M22	1000	20.5	1.2	4.1	2	
M23	1000	21.4	1.2	4.5	2	
M24	500	22.2	1.2	4.2	2	
M25	500	23.2	1.2	4.3	2	
M26	500	24.2	1.2	4.4	2	
M28	500	25.9	1.5	4.6	2	
M29	500	26.9	1.5	4.7	2	
M30	400	27.9	1.5	4.8	2	
M32	400	29.6	1.5	5	2.5	
M34	300	31.5	1.5	5.3	2.5	
M35	300	32.2	1.5	5.4	2.5	
M36	200	33.2	1.75	5.4	2.5	
M38	200	35.2	1.75	5.6	2.5	
M40	200	37	1.75	5.8	2.5	
M42	200	38.5	1.75	6.2	2.5	
M45	200	41.5	1.75	6.3	2.5	
M48	100	44.5	1.75	6.5	2.5	
M50	100	45.8	2	6.7	2.5	
M52	100	47.8	2	6.8	2.5	
M55	100	50.8	2	7	2.5	
M56	100	51.8	2	7	2.5	
M58	100	53.8	2	7.1	2.5	
M60	100	55.8	2	7.2	2.5	
M62	100	57.8	2	7.2	2.5	
M63	100	58.8	2	7.3	2.5	
M65	50	60.8	2.5	7.4	2.5	
M68	50	63.8	2.5	7.8	2.5	

	Box q'ty	SIZE				pcs / Box
		d3	t	a	d0	
M70	50	65.5	2.5	7.8	2.5	
M72	50	67.5	2.5	7.9	2.5	
M75	50	70.5	2.5	7.9	2.5	
M78	50	73.5	2.5	8.1	2.5	
M80	50	74.5	2.5	8.2	2.5	
M82	50	76.5	2.5	8.3	3	
M85	50	79.5	3	8.4	3	
M90	50	84.5	3	8.7	3	
M95	50	89.5	3	9.1	3	
M100	50	94.5	3	9.5	3	
M110	50	103	4	10	3	
M120	1	113	4	10.9	3	
M150	1	142	4	12.3	3.5	
M160	1	151	4	12.9	3.5	
M200	1	190.5	4		4	

RINGS /
THREADED
RODS

Retaining Rings-C Type JIS B 2804

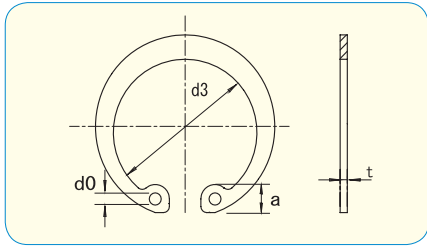

●Material
Stainless Steel A2



	Box q'ty	SIZE				pcs / Box
		d3	t	a	d0	
M6.4	2000	6.9	0.4	1.6	0.8	
M8	2000	8.6	0.4	1.7	0.8	
M9.5	2000	10.3	0.6	2.1	1	
M10	2000	10.7	1	2.8	1.2	
M11	2000	11.8	1	3	1.2	
M12	2000	13	1	3.1	1.5	
M13	2000	14.1	1	3.1	1.5	
M14	2000	15.1	1	3.6	1.7	
M15	2000	16.2	1	3.6	1.7	
M16	2000	17.3	1	3.7	1.7	
M17	2000	18.3	1	3.8	1.7	
M18	2000	19.5	1	4	1.7	
M19	2000	20.5	1	4	2	
M20	1000	21.5	1	4	2	
M21	1000	22.5	1	4.1	2	
M22	1000	23.5	1	4.1	2	
M24	1000	25.9	1.2	4.3	2	
M25	500	26.9	1.2	4.4	2	
M26	500	27.9	1.2	4.6	2	
M28	500	30.1	1.2	4.6	2	
M30	500	32.1	1.2	4.7	2	
M32	500	34.4	1.2	5.2	2.5	
M34	300	36.5	1.5	5.2	2.5	
M35	300	37.8	1.5	5.2	2.5	
M36	300	38.8	1.5	5.2	2.5	
M37	200	39.8	1.5	5.2	2.5	
M38	200	40.8	1.5	5.3	2.5	
M40	200	43.5	1.75	5.7	2.5	
M42	200	45.5	1.75	5.8	2.5	
M45	200	48.5	1.75	5.9	2.5	
M46	200	49.7	1.75	6.1	2.5	
M47	200	50.5	1.75	6.1	2.5	
M48	100	51.5	1.75	6.2	2.5	
M50	100	54.2	2	6.5	2.5	
M52	100	56.2	2	6.5	2.5	
M55	100	59.2	2	6.5	2.5	
M56	100	60.2	2	6.6	2.5	
M58	100	62.2	2	6.8	2.5	
M60	100	64.2	2	6.8	2.5	
M62	100	66.2	2	6.9	2.5	
M63	100	67.2	2	6.9	2.5	
M65	50	69.2	2.5	7	2.5	
M68	100	72.5	2.5	7.4	2.5	

	Box q'ty	SIZE				pcs / Box
		d3	t	a	d0	
M70	50	74.5	2.5	7.4	2.5	
M72	50	76.5	2.5	7.4	2.5	
M75	50	79.5	2.5	7.8	2.5	
M78	50	82.5	2.5	8	2.5	
M80	50	85.5	2.5	8	2.5	
M82	50	87.5	2.5	8	3	
M85	50	90.5	3	8	3	
M90	50	95.5	3	8.3	3	
M95	50	100.5	3	8.5	3	
M100	50	105.5	3	8.8	3	
M110	1	117	4	10.2	3	
M120	1	127	4	10.7	3	
M150	1	158	4	11.8	3.5	
M160	1	169	4	12.5	3.5	
M200	1	209.5	4		4	

RINGS /
THREADED
RODS

Retaining Rings-E Type JIS B 2804

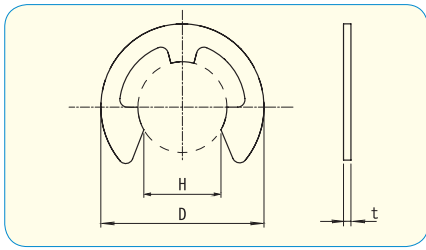

RoHS Directive Compliance



●Material · plating

Steel / Zinc 3Cr. Plated

●Material

Stainless Steel A2

	Box q'ty	SIZE			pcs / Box
		D	H	t	
M1.5	2000	4	1.3	0.4	
M2	2000	5	1.7	0.4	
M2.5	2000	6	2.1	0.4	
M3	2000	7	2.6	0.6	
M4	2000	9	3.5	0.6	
M5	2000	11	4.3	0.6	
M6	2000	12	5.2	0.8	
M7	2000	14	6.1	0.8	
M8	2000	16	6.9	0.8	
M9	2000	18	7.8	0.8	
M10	2000	20	8.7	1	
M12	1000	23	10.4	1	
M15	500	29	13	1.6	

	Box q'ty	SIZE			pcs / Box
		D	H	t	
M0.8	2000	2	0.7	0.2	
M1.2	2000	3	1	0.3	
M1.5	2000	4	1.3	0.4	
M2	2000	5	1.7	0.4	
M2.5	2000	6	2.1	0.4	
M3	2000	7	2.6	0.6	
M4	2000	9	3.5	0.6	
M5	2000	11	4.3	0.6	
M6	2000	12	5.2	0.8	
M7	2000	14	6.1	0.8	
M8	2000	16	6.9	0.8	
M9	2000	18	7.8	0.8	
M10	2000	20	8.7	1	
M12	1000	23	10.4	1	
M15	500	29	13	1.6	
M19	400	37	16.5	1.6	
M24	200	44	20.8	2	



THREADED RODS

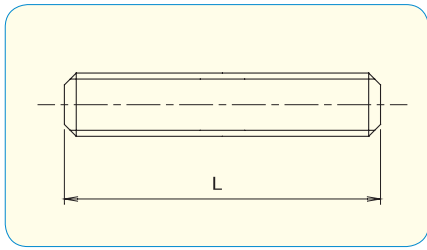

● **Material**

Steel / Zinc 3Cr. Plated

Steel / Zinc Black 3Cr. Plated



RoHS Directive Compliance

pcs / Box

L \ d	M6	M8	M10	M12	M16
20	500	250	200	* 250	
25	500	250	200	* 250	
30	300	200	150	* 150	* 100
35	300	200	150	* 150	* 100
40	250	150	150	* 120	* 70
45	250	150	150	* 120	* 70
50	250	150	150	* 120	* 50
55	* 250	* 150	* 150	* 120	* 50
60	* 250	* 150	* 120	* 100	* 50
65	* 250	* 150	* 120	* 100	* 50
70	* 250	* 150	* 120	* 100	* 50
75	* 250	* 150	* 120	* 100	* 50
80	* 250	* 150	* 100	* 80	* 40
85	* 250	* 150	* 100	* 80	* 40
90	* 250	* 150	* 100	* 80	* 40
95	* 250	* 150	* 100	* 80	* 40
100	* 250	* 150	* 100	* 80	* 40

* ... Zinc 3Cr. Plated only

THREADED RODS

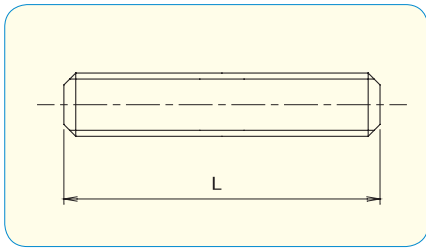

- Material
Stainless Steel A2



RoHS Directive Compliance

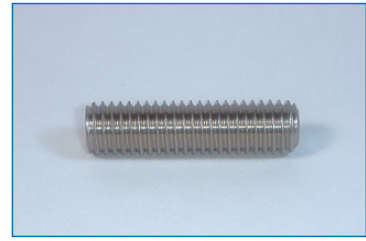

pcs / Box

d \ L	M4	M5	M6	M8	M10	M12	M16	M20
20	500	500	500	250	200			
25	500	500	500	250	200	150		
30	500	500	500	250	200	150	50	
35	500	500	300	200	200	120		
40	500	500	300	200	200	120	50	
45	500	400	300	200	150	120		
50	500	400	300	200	150	120	50	50
55	400	400	250	150	120	100		
60	400	400	250	150	120	100	50	50
65	400	300	250	150	120	100		
70	400	300	250	150	120	100	50	50
75	300	300	250	150	100	80		
80		300	250	150	100	80	50	50
85		250	250	150	100	80		
90		250	250	150	100	80	50	50
100		250	250	150	100	80	50	50
110			200	100	80	50	50	50
120			200	100	80	50	50	50
130			200	100	80	50	50	50
140			200	100	80	50	50	50
150			200	100	80	50	50	50
160			100	100	50	50	30	30
170			100	100	50	50	30	30
180			100	100	50	50	30	30
190			100	100	50	50	30	30
200			100	100	50	50	30	30
210			100	100	50	50	30	30
220			100	100	50	50	30	30
230			100	100	50	50	30	30
240			100	100	50	50	30	30
250			100	100	50	50	30	30
260				100	50	50	30	30
270				100	50	50	30	30
280				100	50	50	30	30
290				100	50	50	30	30
300				100	50	50	30	30

RINGS /
THREADED
RODS

THREADED RODS for chemical anchors

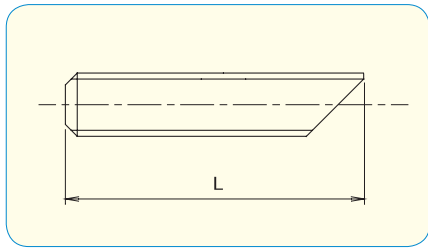

● Material
Stainless Steel A2



RoHS Directive Compliance

L \ d	pcs / Box						
	M8	M10	M12	M16	M20	M22	M24
70	150						
80	150	100					
90	150	100					
100	150	100	80				
110	100	80	50				
120	100	80	50	50			
130	100	80	50	50			
140	100	80	50	50			
150	100	80	50	50	40		
160		80	50	50	40		
170		80	50	50			
180		80	50	50	40		
190			50	50			
200			50	50	40	20	
210			50	50			
220			50	50	40		
230			50	50		20	20
240			50	50	40		
250			50	50	40	20	20
260				50	40		
270				50			
280				50	40	20	20
300				50	40	20	20
320				40	40		
330						15	10
340				40	35		
350				40	35	15	10
360					35		
380					30	15	10
400					30	15	10
450					25	10	10
500					25	10	10

RINGS /
THREADED
RODS