

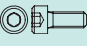





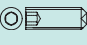
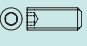
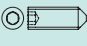
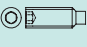

# 5. SOCKET SCREWS

	<b>HEX SOCKET CAP SCREW</b>	Steel / Black , Steel / Zinc 3Cr. Plated , Steel / Zinc Black 3Cr. Plated , Stainless Steel A2 , SUS 316L (Stainless Steel A4) Titan , DISGO , YUS-550 VACUUM SCREWS	P.2~
	<b>HEX SOCKET BUTTON HEAD SCREW</b>	Steel / Zinc 3Cr. Plated , Steel / Zinc Black 3Cr. Plated , Stainless Steel A2 , Titan , VACUUM SCREWS	P.11~
	<b>HEX SOCKET FLAT HEAD SCREW</b>	Steel / Zinc 3Cr. Plated , Steel / Zinc Black 3Cr. Plated , Stainless Steel A2 Titan	P.14~
	<b>HEX SOCKET SET SCREW CUP POINT</b>	Steel / Zinc 3Cr. Plated , Steel / Zinc Black 3Cr. Plated , Stainless Steel A2 , SUS 316L (Stainless Steel A4) Titan	P.16~
	<b>HEX SOCKET SET SCREW FLAT POINT</b>	Steel / Zinc 3Cr. Plated , Steel / Zinc Black 3Cr. Plated , Stainless Steel A2 , SUS 316L (Stainless Steel A4)	P.19~
	<b>HEX SOCKET SET SCREW CONE POINT</b>	Steel / Zinc 3Cr. Plated , Steel / Zinc Black 3Cr. Plated , Stainless Steel A2	P.21
	<b>HEX SOCKET SET SCREW DOG POINT</b>	Steel / Zinc 3Cr. Plated	P.22
	<b>HEX SOCKET CAP SCREW WITH FLANGE</b>	Steel / Zinc 3Cr. Plated , Steel / Zinc Black 3Cr. Plated , Stainless Steel A2	P.23
	<b>HEX SOCKET BUTTON HEAD SCREW WITH FLANGE</b>	Steel / Zinc 3Cr. Plated , Steel / Zinc Black 3Cr. Plated , Stainless Steel A2	P.24
	<b>HEX SOCKET CAP SCREW WITH FLAT WASHER</b>	Steel / Zinc 3Cr. Plated , Steel / Zinc Black 3Cr. Plated , Stainless Steel A2	P.25
	<b>HEX SOCKET CAP SCREW WITH SPRING WASHER</b>	Steel / Zinc 3Cr. Plated , Steel / Zinc Black 3Cr. Plated , Stainless Steel A2	P.26
	<b>HEX SOCKET CAP SCREW WITH SPRING WASHER &amp; FLAT WASHER</b>	Steel / Zinc 3Cr. Plated , Steel / Zinc Black 3Cr. Plated , Stainless Steel A2	P.27~

# HEX SOCKET CAP SCREW ISO 4762 / JIS B1176 / DIN 912

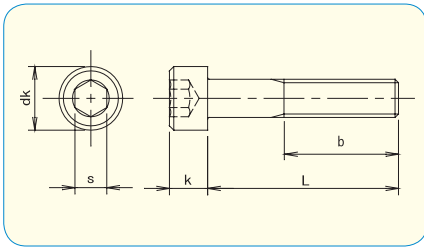

- Material · plating  
Steel 12.9 (~M20) / Black  
Steel 10.9 (M22~) / Black



SOCKET SCREWS

	M1.6	M2	M2.5	M2.6	M3	M4	M5	M6	M8	M10	M12
dk	3	3.8	4.5	4.5	5.5	7	8.5	10	13	16	18
k	1.6	2	2.5	2.6	3	4	5	6	8	10	12
s	1.5	1.5	2	2	2.5	3	4	5	6	8	10
b	15	16	17	17	18	20	22	24	28	32	36

		pcs / Box										
d	L	M1.6	M2	M2.5	M2.6	M3	M4	M5	M6	M8	M10	M12
3	3	1,000	500	500	500	500						
4	4	1,000	500	500	500	500	500	500				
5	5	1,000	500	500	500	500	500	500	200			
6	6	1,000	500	500	500	500	500	500	200			
8	8	1,000	500	500	500	500	500	500	200	100		
10	10	1,000	500	500	500	500	500	500	200	100	100	
12	12		500	500	500	500	500	500	200	100	100	100
14	14		500	500	500	500	500	500	200	100	100	
15	15		500	500	500	500	500	500	200	100	100	100
16	16		500	500	500	500	500	500	200	100	100	100
18	18		500	500	500	500	500	500	200	100	100	100
20	20		500	500	500	500	500	500	200	100	100	100
22	22					500	200	200	200	100	100	100
25	25					200	200	200	200	100	100	100
28	28					200	200	200	200	100	100	100
30	30					200	200	200	100	100	100	100
35	35					200	200	200	100	100	100	50
40	40					200	200	200	100	100	100	50
45	45					200	200	200	100	100	100	50
50	50					200	200	200	100	100	50	50
55	55						200	200	100	100	50	50
60	60						200	200	100	100	50	50
65	65						200	200	100	100	50	50
70	70						200	200	100	100	50	50
75	75								100	100	50	50
80	80								100	100	50	50
85	85								100	100	50	50
90	90								100	100	50	25
95	95								100	50	50	25
100	100								100	50	50	25
105	105									50	50	25
110	110					300				50	50	25
115	115									50	50	25
120	120									50	50	25
125	125									50	25	25
130	130									50	25	25
140	140									50	25	25
150	150									50	30	25
155	155											
160	160										30	25
165	165											
170	170										30	25
180	180										30	25
190	190										30	25
200	200										30	25

# HEX SOCKET CAP SCREW ISO 4762 / JIS B1176 / DIN 912

	M14	M16	M20	M24	M36
dk	21	24	30	36	54
k	14	16	20	24	36
s	12	14	17	19	27
b	40	44	52	60	84

		pcs / Box				
d	L	M14	M16	M20	M24	M36
20		50				
25		50	50			
30		50	50		20	
35		50	40		20	
40		50	40	40		
45		50	40	40		
50		50	30	35		
55		40	30	30		
60		40	30	30		1
65		40	25	30		
70		40	25	25		1
75		40	25	25		
80		40	25	25		1
85		30	25	25		
90		30	20	25		1
95		30	20	25		
100		30	20	20		1
105			20			
110			20			1
115			15			
120			15			1
125			15			
130			15			1
140			15			1
150			15			1
160						1
170						1
180						1
190						1
200						1
210						1
220						1
230						1
240						1
250						1
260						1
280						1
300						1

# HEX SOCKET CAP SCREW ISO 4762 / JIS B1176 / DIN 912

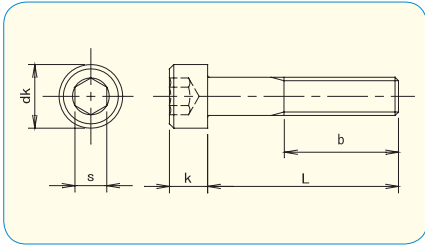

- Material · plating  
Steel 10.9 / Zinc 3Cr. Plated  
Steel 10.9 / Zinc Black 3Cr. Plated



RoHS Directive Compliance



SOCKET SCREWS

	M2	M2.5	M2.6	M3	M4	M5	M6	M8	M10	M12
dk	3.8	4.5	4.5	5.5	7	8.5	10	13	16	18
k	2	2.5	2.6	3	4	5	6	8	10	12
s	1.5	2	2	2.5	3	4	5	6	8	10
b	16	17	17	18	20	22	24	28	32	36

pcs / Box

d L	M2	M2.5	M2.6	M3	M4	M5	M6	M8	M10	M12
3	500	500	500	500						
4	500	500	500	500	500					
5	500	500	500	500	500	500				
6	500	500	500	500	500	500	500			
8	500	500	500	500	500	500	500			
10	500	500	500	500	500	500	500	100	100	
12	500	500	500	500	500	500	500	100	100	
14	500	500	500	500	500	500	500	100	100	
15	500	500	500	500	500	200	200	100	100	
16	500	500	500	500	500	200	200	100	100	
18	500	500	500	500	500	200	200	100	100	
20	500	500	500	500	200	200	200	100	100	
25		500		500	200	200	200	100	100	50
30				500	200	200	200	100	50	50
35				500	200	200	100	100	50	50
40				500	200	200	100	100	50	50
45				500	200	200	100	100	50	50
50				200	200	200	100	100	50	
55				200	200	200	100	50	50	
60				200	200	200	100	50	50	40
65						200	100			
70					200	200	100		50	
75					200		100			
80						100	100			
85					100					
90							100			
100							100	50	30	
110										
120								50		

# HEX SOCKET CAP SCREW ISO 4762 / JIS B1176 / DIN 912

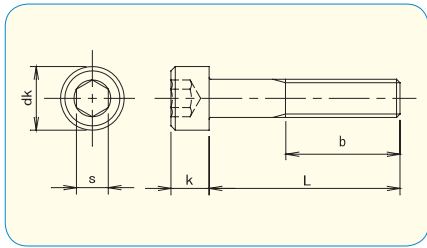

●Material  
Stainless Steel A2



	M1.6	M2	M2.5	M2.6	M3	M4	M5	M6	M8	M10
dk	3	3.8	4.5	4.5	5.5	7	8.5	10	13	16
k	1.6	2	2.5	2.6	3	4	5	6	8	10
s	1.5	1.5	2	2	2.5	3	4	5	6	8
b	15	16	17	17	18	20	22	24	28	32

		pcs / Box								
L \ d	M1.6	M2	M2.5	M2.6	M3	M4	M5	M6	M8	M10
3	1,000	1,000	1,000	1,000	1,000					
4	1,000	1,000	1,000	1,000	500	1,000				
5	1,000	1,000	1,000	1,000	500	500	500			
6	1,000	1,000	1,000	1,000	500	500	500	500		
8	1,000	1,000	1,000	1,000	500	500	500	200	100	
10	1,000	1,000	1,000	1,000	500	500	500	200	100	100
12	1,000	1,000	1,000	1,000	500	500	500	200	100	100
14		1,000	1,000	1,000	500	500	500	200	100	100
15		1,000	1,000	1,000	500	500	500	200	100	100
16		1,000	1,000	1,000	500	500	200	200	100	100
18		1,000	1,000	1,000	500	500	200	200	100	100
20		1,000	1,000	1,000	500	500	200	200	100	100
22					200	500	200	200	100	100
25		1,000	1,000	1,000	200	500	200	200	100	100
28					200	200	200	200	100	100
30		1,000	1,000	1,000	200	200	200	200	100	50
35					200	200	200	200	100	50
40		1,000	1,000	1,000	200	200	200	200	100	50
45					200	200	100	200	100	50
50					200	200	100	200	100	50
55					200	200	100	100	50	50
60					200	200	100	100	50	50
65					200	200	100	100	50	50
70					200	200	100	100	50	40
75					200	200	100	100	50	40
80					200	200	100	100	50	40
85					200	200	100	100	50	40
90					200	200	100	100	50	30
95					200	100	100	100	50	30
100					200	100	100	100	50	30
105							100	100	50	25
110						100	100	100	50	30
115						100	100	100	50	25
120						100	100	100	50	30
125							100	100	50	25
130						100	100	100	50	30
140						100	100	100	50	30
150						100	100	100	50	30
155							100		50	30
160							100	100	50	30
165										30
170							100	100	50	30
180							100	100	70	30
190							100	100	70	30
200							100	100	70	30
210									70	
220									50	30
230									50	30
240										
250									50	30

# HEX SOCKET CAP SCREW ISO 4762 / JIS B1176 / DIN 912

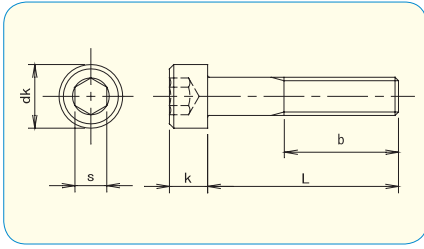

● Material  
Stainless Steel A2



SOCKET SCREWS

	M12	M14	M16	M18	M20	M22	M24	M27	M30	M33	M36
dk	18	21	24	27	30	33	36	40	45	50	54
k	12	14	16	18	20	22	24	27	30	33	36
s	10	12	14	14	17	17	19	19	22	24	27
b	36	40	44	48	52	56	60	66	72	78	84

L	pcs / Box										
	M12	M14	M16	M18	M20	M22	M24	M27	M30	M33	M36
12	50										
14	50										
15	50										
16	50										
18	50										
20	50	40	40								
22	50										
25	50	40	50		20						
30	50	40	50	10	20	15	5				
35	50	40	50	10	20	15	5				
40	50	30	40	10	20	15	5				
45	50	30	40	10	15	15	5				
50	40	30	40	10	15	15	5	5	4		
55	40	25	35	10	15	15	5	5	4		
60	30	25	30	10	15	15	5	5	4		
65	30	25	30	10	15	15	5	5	4		
70	30	25	30	10	15	15	5	5	4	1	1
75	30	25	25	10	12	15	5	5	4	1	1
80	30	25	25	10	12	15	5	5	4	1	1
85	30	25	25	10	10	15	5	5	4	1	1
90	25	25	25	10	10	15	5	5	4	1	1
95	25	15	20		10	15	5	5	4		1
100	25	15	20	10	10	15	5	5	4	1	1
105	25	15	15			15	5				
110	20	15	15	10	10	15	5	5	4	1	1
115	20	15	15			15	5				
120	20	15	12	10	8	15	5	5	4	1	1
125	20	15	15			10	5				
130	20	15	12	10	8	10	5	5	4	1	1
140	20	15	12	10	8	10	5	5	4	1	1
150	20	15	12	10	6	10	5	5	4	1	1
160	20	15	12	10	6	10	5	5	4		1
170	20	15	12	10	6	10	5	5	4		1
180	20	15	12	10	6	10	5	5	4		1
190	20	15	12		6	10	5	5	3		1
200	20	15	10	10	6	10	5	5	3		1
210			10								
220	20		10								
230	20		10		6		5		3		
240	20		10								
250	20	20	10		6	10	5	5	3		1
260			10								
280							5				
300	20	15	10		5	10	5	5	3		1

# HEX SOCKET CAP SCREW ISO 4762 / JIS B1176 / DIN 912

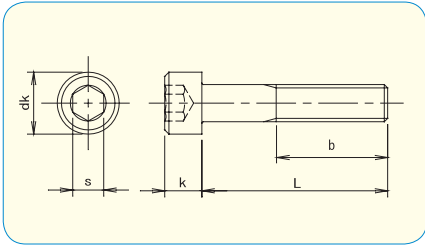

● Material  
**SUS 316L**  
 Stainless Steel A4



	M3	M4	M5	M6	M8	M10	M12	M14
dk	5.5	7	8.5	10	13	16	18	21
k	3	4	5	6	8	10	12	14
s	2.5	3	4	5	6	8	10	12



SOCKET SCREWS

		pcs / Box						
L \ d	M3	M4	M5	M6	M8	M10	M12	M14
4	500	500						
5	500	500	300					
6	500	500	300	300				
8	500	500	300	300				
10	500	500	300	300	200			
12	500	500	300	300	200			
14	500	500	300	300	200			
15	500	500	300	300	200	100	100	
16	500	500	300	300	200	100	100	
18	500	500	300	300	200			
20	500	500	300	300	200	100	100	
25	* 500	500	300	300	200	100	100	30
30	* 500	* 500	* 300	300	200	100	100	30
35	* 500	* 500	* 300	* 300	200	100	100	30
40	* 500	* 500	* 300	* 300	* 200	100	100	30
45	* 500	* 500	* 300	* 300	* 200	* 100	100	30
50	* 500	* 500	* 300	* 300	* 200	* 100	* 100	30
55		* 500	* 300	* 300	* 200	* 100	* 100	
60		* 500	* 300	* 300	* 200	* 100	* 100	* 30
65		* 500	* 300	* 300	* 200	* 100	* 100	
70		* 500	* 300	* 300	* 200	* 100	* 100	
75		* 500	* 300	* 300	* 200	* 100	* 100	
80		* 500	* 300	* 300	* 200	* 100	* 100	
85				* 300	* 200		* 100	
90				* 300	* 200	* 100	* 100	
95				* 300	* 200			
100				* 300	* 200	* 100	* 100	
110						* 100	* 100	
120						* 100	* 100	
130						* 100	* 100	
140						* 100	* 100	
150						* 100	* 100	

\* ... Half thread

**HEX SOCKET CAP SCREW ISO 4762 / JIS B1176 / DIN 912**

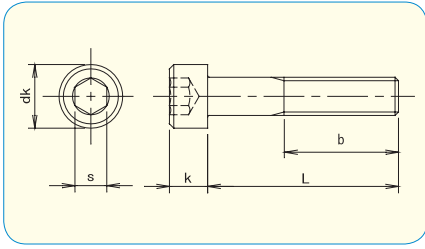

RoHS Directive Compliance

SOCKET SCREWS

	M3	M4	M5	M6	M8	M10	M12	M16
dk	5.5	7	8.5	10	13	16	18	24
k	3	4	5	6	8	10	12	16
s	2.5	3	4	5	6	8	10	14

● Material **TITAN**

pcs / Box

L \ d	M3	M4	M5	M6	M8	M10	M12
6	200	200					
8	200	200	100	100			
10	200	200	100	100			
12	200	200	100	100			
15	200	200	100	100	100	50	
16	200	200	100	100	100	50	
20	200	200	100	100	100	50	
25	* 200	200	100	100	100	50	30
30		* 200	* 100	100	100	50	30
35		* 200	* 100	* 100	100	50	30
40		* 200	* 100	* 100	* 100	50	30
45			* 100	* 100	* 100	* 50	30
50			* 100	* 100	* 100	* 50	30
55			* 100	* 100	* 100	* 50	* 30
60			* 100	* 100	* 100	* 50	* 30



\* ... Half thread

● Material · plating Steel 12.9 / **DISGO**

pcs / Box

L \ d	M6	M8	M10	M12	M16
10	200	100			
12	200	100			
14	200	100			
15	200	100			
16	200	100	100		
18	200	100			
20	200	100	100	50	
22	200	100			
25	200	100	100	50	
30	200	100	50	50	40
35	* 200	100	50	50	40
40	* 200	* 100	50	50	30
45	* 200	* 100	* 50	50	30
50	* 200	* 100	* 50	40	30
55		* 50	* 50	* 40	25
60		* 50	* 50	* 30	25
65		* 50	* 50	* 30	* 25
70			* 40	* 30	* 20
75			* 40	* 30	* 20
80			* 40	* 30	* 20
90				* 25	* 15
100				* 25	* 15



**High Rustproof Plating**

**DISGO**

- No Hydrogen-Embrittlement.
- No Cr. contained.
- Special plating for High tensile Fasteners. (class 8.8 / 10.9 / 12.9)

\* ... Half thread





# HEX SOCKET CAP SCREW ISO 4762 / JIS B1176 / DIN 912

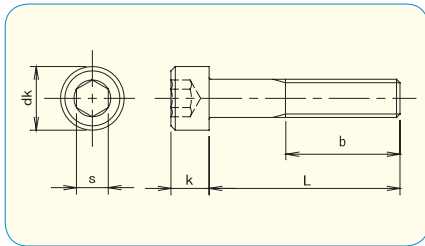

● Material  
YUS-550



	M2	M2.5	M3	M4	M5	M6	M8	M10	M12	M16
dk	3.8	4.5	5.5	7	8.5	10	13	16	18	24
k	2	2.5	3	4	5	6	8	10	12	16
s	1.5	2	2.5	3	4	5	6	8	10	14

		pcs / Box									
L \ d	M2	M2.5	M3	M4	M5	M6	M8	M10	M12	M16	
3	2000										
4	2000	2000									
5	2000	2000	2000								
6	2000	2000	2000	1000							
8	2000	2000	2000	1000	500						
10	2000	2000	1000	1000	500	200					
12	2000	2000	1000	500	200	200	200				
15	2000	2000	1000	500	200	200	200	100			
16			1000	500	200						
20		2000	1000	500	200	200	200	100			
25			* 1000	500	200	200	100	100			
30			* 1000	* 500	200	200	100	100	100		
35				* 500	* 200	* 100	100	100			
40				* 500	* 200	* 100	100	100	100	50	
45					* 100	* 100	* 100	* 100			
50					* 100	* 100	* 100	* 100	50		
60									* 50	25	
65										* 25	
70									* 50		

\* ... Half thread

### HIGH STRENGTH

YUS-550 has enough hardness to the core, the thread is able not to be transformed and gain high fastening.

### HIGH TOUGHNESS

Generally, stainless which has high tensile strength or hardness doesn't have toughness. But YUS-550 has high toughness with keeping these performance.

### HIGH RUSTPROOF

YUS-550 has rustproof more than the equal to SUS XM7 / SUS 304.

# HEX SOCKET CAP SCREW WITH CENTER HOLE

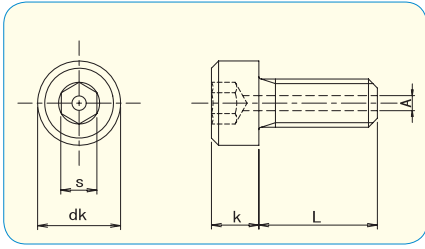

RoHS Directive Compliance

SOCKET SCREWS

	M3	M4	M5	M6	M8	M10	M12
dk	5.5	7	8.5	10	13	16	18
k	3	4	5	6	8	10	12
s	2.5	3	4	5	6	8	10
A	1.2	1.5	1.5	2	2	3	3

**Material**  
Stainless Steel A2

pcs / Box

L \ d	M3	M4	M5	M6	M8	M10	M12
5	20	20					
6	20	20	10				
8	20	20	10	10			
10	20	20	10	10			
12	20	20	10	10	10		
16	20	20	10	10	10	5	
20		20	10	10	10	5	
25		20	10	10	10	5	
30		10	10	10	10	5	5
35		10	10	10	10	5	5
40			10	10	10	5	5
45				10	10	5	5
50				10	10	5	5
60					5	5	5

\* ... Half thread

**Material**  
Stainless Steel A2, Special Chemical Polish

pcs / Box

L \ d	M3	M4	M5	M6	M8	M10	M12
5	20	20					
6	20	20	10				
8	20	20	10	10			
10	20	20	10	10			
12	20	20	10	10	10		
16	20	20	10	10	10	5	
20		20	10	10	10	5	
25		20	10	10	10	5	
30		10	10	10	10	5	5
35		10	10	10	10	5	5
40			10	10	10	5	5
45				10	10	5	5
50				10	10	5	5
60					5	5	5

\* ... Half thread

# HEX SOCKET BUTTON HEAD SCREW ISO 7380 / JIS B1174

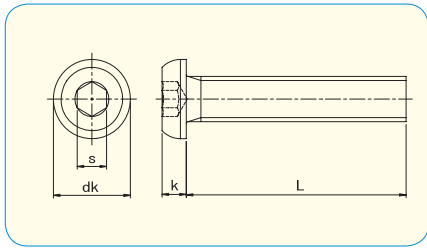

- **Material · plating**  
 Steel 10.9 / Zinc 3Cr. Plated  
 Steel 10.9 / Zinc Black 3Cr. Plated



	M3	M4	M5	M6	M8	M10
dk	5.7	7.6	9.5	10.5	14	17.5
k	1.65	2.2	2.75	3.3	4.4	5.5
s	2	2.5	3	4	5	6

		pcs / Box					
L \ d	M3	M4	M5	M6	M8	M10	
5	1000	1000					
6	1000	1000	400	400			
8	1000	1000	400	400			
10	1000	1000	400	400	200		
12	1000	1000	400	200	100		
14	1000	1000	400	200	100		
15	1000	1000	400	200	100	100	
16	1000	1000	400	200	100	100	
18	1000	1000	200	200	100	100	
20	1000	1000	200	200	100	100	
25	800	800	200	200	100	100	
30	800	800	200	100	100	100	
35	800	600	200	100	100	100	
40	800	600	200	100	100	100	
45		600	200	100	100	100	
50		600	200	100	100	50	
55			200	100	100	50	
60			200	100	100	50	
65				100	100	50	
70					100	50	

# HEX SOCKET BUTTON HEAD SCREW ISO 7380 / JIS B1174

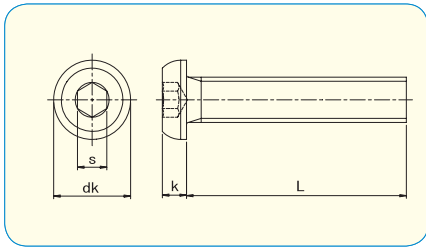

● **Material**  
Stainless Steel A2



	M3	M4	M5	M6	M8	M10	M12	M16
dk	5.7	7.6	9.5	10.5	14	17.5	21	28
k	1.65	2.2	2.75	3.3	4.4	5.5	6.6	8.8
s	2	2.5	3	4	5	6	8	10

SOCKET SCREWS

		pcs / Box							
L \ d	M3	M4	M5	M6	M8	M10	M12	M16	
3									
4	500								
5	500	500							
6	500	500	500						
8	500	500	500	300					
10	500	500	500	300	200				
12	500	500	500	300	200	100			
14	500	500	500	300	200				
15	500	500	500	300	200	100			
16	500	500	500	300	200	100	100		
18	500	500	500	300	200				
20	500	500	500	300	200	100	100		
22	500	500	500	300	200	100			
25	500	500	500	300	200	100	100	20	
30	500	500	500	300	200	100	100	20	
35	500	500	500	300	200	100	100	20	
40	500	500	500	300	200	100	100	20	
45	500	500	500	300	200	100	100	20	
50	500	500	500	300	200	100	100	20	
55		500	500	300	200	100	100	20	
60		500	500	300	200	100	100	20	
65			500	300	200	100	100	20	
70			500	300	200	100	100	20	
75			500	300	200	100	100	20	
80			500	300	200	100	100	20	
85						100	100	20	
90				300	200	100	100	20	
95								20	
100				300	200	100	100	20	

**HEX SOCKET BUTTON HEAD SCREW WITH CENTER HOLE**

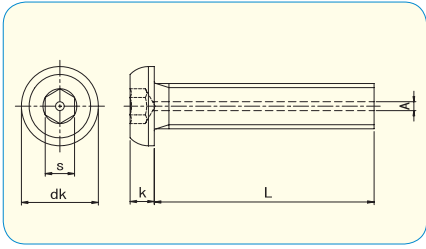

	M3	M4	M5	M6
dk	5.7	7.6	9.5	10.5
k	1.65	2.2	2.75	3.3
s	2	2.5	3	4
A	1.2	1.5	1.5	2



● **Material**  
Stainless Steel A2

		pcs / Box			
L \ d	M3	M4	M5	M6	
5	20				
6	20	20	10		
8	20	20	10	10	
10	20	20	10	10	
12	20	20	10	10	
16		20	10	10	
20			10	10	
25				10	

● **Material**  
Stainless Steel A2, Special Chemical Polish

		pcs / Box			
L \ d	M3	M4	M5	M6	
5	20				
6	20	20	10		
8	20	20	10	10	
10	20	20	10	10	
12	20	20	10	10	
16		20	10	10	
20			10	10	
25				10	

SOCKET SCREWS

**HEX SOCKET BUTTON HEAD SCREW ISO 7380 / JIS B1174**

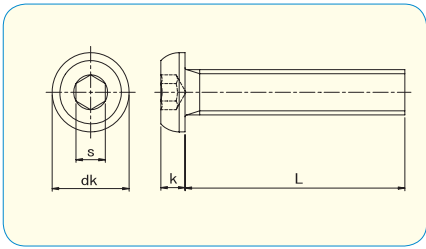

● **Material**  
**TITAN**



	M3	M4	M5	M6	M8
dk	5.7	7.6	9.5	10.5	14
k	1.65	2.2	2.75	3.3	4.4
s	2	2.5	3	4	5

		pcs / Box				
L \ d	M3	M4	M5	M6	M8	
6	1000					
8	1000	1000	1000	500		
10	1000	1000	500	500		
12	1000	1000	500	500	200	
15	1000	1000	500	500	200	
16	1000	1000	500	500	200	
20	1000	1000	500	500	200	
25		1000	500	500	200	
30		1000	500	500	200	

## HEX SOCKET FLAT HEAD SCREW JIS B1194 / DIN 7991

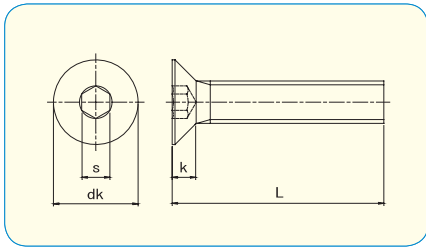

	M3	M4	M5	M6	M8	M10
dk	6.72	8.96	11.2	13.44	17.92	22.4
k	1.86	2.48	3.1	3.72	4.96	6.2
s	2	2.5	3	4	5	6

### Material - plating

Steel 10.9 / Zinc 3Cr. Plated

Steel 10.9 / Zinc Black 3Cr. Plated

pcs / Box

L \ d	M3	M4	M5	M6	M8	M10
5	1000					
6	1000	1000	400			
8	1000	1000	400	400		
10	1000	1000	400	400	200	
12	1000	1000	400	200	100	
14	1000	1000	400	200	100	
15	1000	1000	400	200	100	100
16	1000	1000	400	200	100	100
18	1000	1000	200	200	100	100
20	1000	1000	200	200	100	100
25	800	800	200	200	100	100
30	800	800	200	100	100	100
35	600	600	200	100	100	100
40	800	600	200	100	100	100
45		600	200	100	100	100
50		600	200	100	100	50
55			200	100	100	50
60			200	100	100	50
65					100	50
70					100	50

### Material **TITAN**

pcs / Box

L \ d	M3	M4	M5	M6	M8
6	1000				
8	1000	1000	1000	500	
10	1000	1000	500	500	
12	1000	1000	500	500	200
15	1000	1000	500	500	200
16	1000	1000	500	500	200
20	1000	1000	500	500	200
25		1000	500	500	200
30		1000	500	500	200

# HEX SOCKET FLAT HEAD SCREW JIS B1194 / DIN 7991

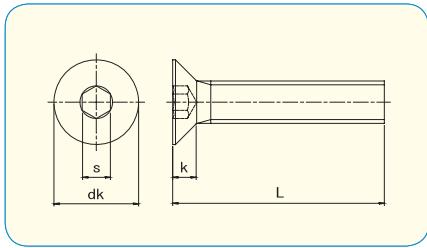

●Material  
Stainless Steel A2



	M3	M4	M5	M6	M8	M10	M12	M14	M16	M20
dk	6.72	8.96	11.2	13.44	17.92	22.4	26.88	30.8	33.6	40.32
k	1.86	2.48	3.1	3.72	4.96	6.2	7.44	8.4	8.8	10.16
s	2	2.5	3	4	5	6	8	10	10	12

		pcs / Box									
L	d	M3	M4	M5	M6	M8	M10	M12	M14	M16	M20
3											
4	500										
5	500	500									
6	500	500	500								
8	500	500	500	300							
10	500	500	500	300	200						
12	500	500	500	300	200						
14	500	500	500	300	200	100					
15	500	500	500	300	200	100					
16	500	500	500	300	200	100					
18	500	500	500	300	200	100					
20	500	500	500	300	200	100	100				
22	500	500	500	300	200	100					
25	500	500	500	300	200	100	100		20		
30	500	500	500	300	200	100	100	20	20	10	
35	500	500	500	300	200	100	100		20	10	
40	500	500	500	300	200	100	100	20	20	10	
45	500	500	500	300	200	100	100		20	10	
50	500	500	500	300	200	100	100	20	20	10	
55		500	500	300	200	100	100		20	10	
60		500	500	300	200	100	100	20	20	10	
65			500	300	200	100	100		20	10	
70			500	300	200	100	100	20	20	10	
75			500	300	200	100	100		20	10	
80			500	300	200	100	100	20	20	10	
85											
90				300	200	100	100	20	20	10	
95											
100				300	200	100	100	20	20	10	
110						100					
120						100					
130						100					
140						100					
150						100					

SOCKET  
SCREWS

# HEX SOCKET SET SCREW CUP POINT ISO 4029 / JIS B1177 / DIN 916

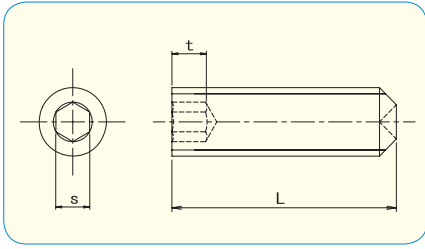

- Material · plating  
Steel 45H / Zinc 3Cr. Plated  
Steel 45H / Zinc Black 3Cr. Plated



	M2	M2.5	M3	M4	M5	M6	M8	M10
s	0.9	1.3	1.5	2	2.5	3	4	5
t	1.7	2	2	2.5	3	3.5	5	6

SOCKET  
SCREWS

pcs / Box

L \ d	M2	M2.5	M3	M4	M5	M6	M8	M10
2	1000							
3	1000		1000	1000				
4	1000	1000	1000	1000	1000			
5	1000	1000	1000	1000	1000			
6		1000	1000	1000	1000	1000		
8			1000	1000	1000	1000	500	
10	1000		1000	1000	1000	1000	500	
12			1000	1000	1000	1000	500	
14				1000	1000			
15			1000	1000	1000	1000		
16			1000	1000	1000	1000		
18			1000	1000				
20			1000	1000	1000	1000	500	* 500
22						500		
25	1000			1000	500	500	500	
30					500	500	200	
35						500	200	
40						500	200	

\* ... Zinc 3Cr. Plated only



# HEX SOCKET SET SCREW CUP POINT ISO 4029 / JIS B1177 / DIN 916

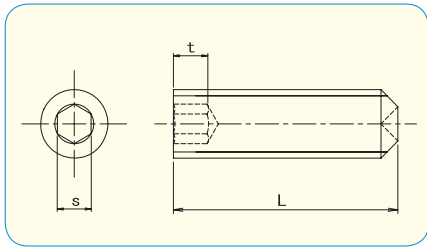

● Material  
Stainless Steel A2



	M1.6	M2	M2.5	M3	M4	M5	M6	M8	M10	M12	M16
s	0.7	0.9	1.3	1.5	2	2.5	3	4	5	6	8
t	1.5	1.7	2	2	2.5	3	3.5	5	6	8	10

pcs / Box

L \ d	M1.6	M2	M2.5	M3	M4	M5	M6	M8	M10	M12	M16
2	300	300									
2.5	300	300	300	300							
3	300	300	300	300	300	200					
4	300	300	300	300	300	200					
5	300	300	300	300	300	200	200				
6	300	300	300	300	300	200	200	100			
8	300	300	300	300	300	200	200	100	100		
10		300	300	300	300	200	200	100	100	100	
12		300	300	300	300	200	200	100	100	100	
14				300	300	200	200	100	100	100	
15		300	300	300	300	200	200	100	100	100	30
16		300	300	300	300	200	200	100	100	100	30
18				300	300	200	200	100	100	100	
20				300	300	200	200	100	100	100	30
22				300	300	200	200	100	100	100	
25				300	300	200	200	100	100	100	30
30				300	300	200	200	100	100	100	30
35				300	300	200	200	100	100	100	30
40				300	300	200	200	100	100	100	30
45					300	200	200	100	100	100	30
50					300	200	200	100	100	100	30
55							200	100	100	100	30
60							200	100	100	100	30
65									100	100	30
70									100	100	30
75									100	100	30
80									100	100	30
90											30
100											30

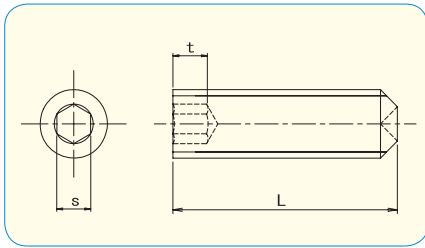
**SUS 316L****TITAN****HEX SOCKET SET SCREW CUP POINT ISO 4029 / JIS B1177 / DIN 916**

	M3	M4	M5	M6	M8	M10	M12
s	1.5	2	2.5	3	4	5	6
t	2	2.5	3	3.5	5	6	8

**SOCKET  
SCREWS**● **Material****SUS 316L** Stainless Steel A4

		pcs / Box					
L \ d	M3	M4	M5	M6	M8	M10	M12
3	200						
4	200	200					
5	200	200	200				
6	200	200	200	100			
8	200	200	200	100	100		
10	200	200	200	100	100	100	
12	200	200	200	100	100	100	100
14	200	200	200	100	100		
15	200	200	200	100	100	100	100
16	200	200	200	100	100	100	100
18	200	200	200	100	100	100	100
20	200	200	200	100	100	100	100
25		200	200	100	100	100	100
30		200	200	100	100	100	100
35			200	100	100	100	100
40			200	100	100	100	100
45				100	100	100	100
50				100	100	100	100
60						100	100

● **Material****TITAN**

		pcs / Box			
L \ d	M4	M5	M6	M8	
6	200	150	150		
8	200	150	150	100	
10	200	150	150	100	
12	200	150	150	100	
15	200	150	150	100	
20			150	100	



# HEX SOCKET SET SCREW FLAT POINT ISO 4026 / JIS B1177 / DIN 913

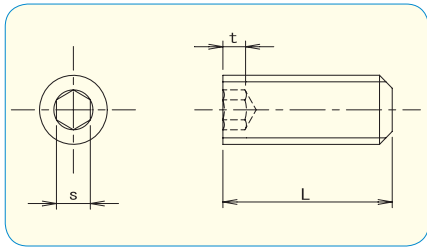

- **Material · plating**  
 Steel 45H / Zinc 3Cr. Plated  
 Steel 45H / Zinc Black 3Cr. Plated



	M2	M2.5	M3	M4	M5	M6	M8	M10	M12
s	0.9	1.3	1.5	2	2.5	3	4	5	6
t	1.7	2	2	2.5	3	3.5	5	6	8

pcs / Box

L \ d	M2	M2.5	M3	M4	M5	M6	M8	M10	M12
2	1000	** 1000							
3	** 1000	1000	1000	** 1000					
4	1000	** 1000	1000	1000	1000				
5	1000	1000	1000	1000	1000	1000			
6	** 1000		1000	1000	1000	1000			
8	** 1000	** 1000	1000	1000	1000	1000	500		
10	** 1000	** 1000	1000	1000	1000	1000	500	500	
12			1000	1000	** 1000	1000		500	* 500
14			** 1000	1000				500	
15			1000	1000	1000	1000	500	** 500	
16			1000	1000	1000	* 1000			
18				* 1000	** 1000	** 1000			
20			** 1000	* 1000	1000	1000	500	** 500	
25			** 1000	** 1000	500	500	** 500	200	
30				** 1000	500	** 500	200	200	
35					** 500		** 200	200	
40					** 500		200		

\* ... Zinc 3Cr. Plated only

\*\* ... Zinc Black 3Cr. Plated only

# HEX SOCKET SET SCREW FLAT POINT ISO 4026 / JIS B1177 / DIN 913

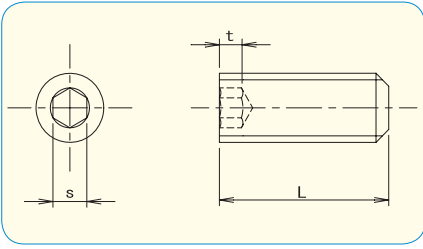

	M3	M4	M5	M6	M8	M10	M12	M16	M20	M24
s	1.5	2	2.5	3	4	5	6	8	10	12
t	2	2.5	3	3.5	5	6	8	10	12	15

SOCKET SCREWS

**Material**

Stainless Steel A2

pcs / Box

L \ d	M3	M4	M5	M6	M8	M10	M12
3	1000	1000					
4	1000	1000	1000	1000			
5	1000	1000	1000	1000			
6	1000	1000	1000	1000	500		
8	1000	1000	1000	1000	500	500	
10	1000	1000	1000	1000	500	500	
12	1000	1000	1000	1000	500	500	500
14	1000	1000	1000	1000	500	500	
15	1000	1000	1000	1000	500	500	500
16	1000	1000	1000	1000	500	500	
18	1000	1000	1000	1000	500	500	200
20	1000	1000	1000	1000	500	500	200
25		1000	500	500	500	200	200
30		1000	500	500	200	200	200
35							200
40					200		100

**Material**

**SUS 316L** Stainless Steel A4

pcs / Box

L \ d	M16	M20	M24
16	30		
20	30	15	
25	30	15	
30	30	15	
35	30	15	
40	30	15	10
45	30	15	
50	30	15	10
60	30	15	10
70	30	15	
80	30	15	10
100	30	15	10



# HEX SOCKET SET SCREW CONE POINT ISO 4027 / JIS B1177 / DIN 914

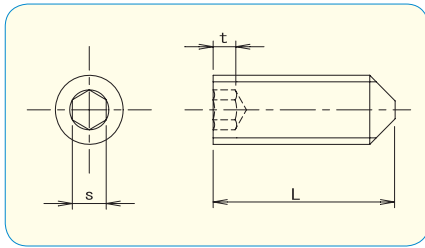

	M2	M2.5	M3	M4	M5	M6	M8	M10	M12
s	0.9	1.3	1.5	2	2.5	3	4	5	6
t	1.7	2	2	2.5	3	3.5	5	6	8

## ● Material · plating

Steel 45H / Zinc 3Cr. Plated

Steel 45H / Zinc Black 3Cr. Plated

pcs / Box

L \ d	M2	M2.5	M3	M4	M5	M6	M8	M10	M12
2	1000								
3	1000	1000	1000						
4	1000	1000	1000	1000	1000				
5	1000	1000	1000	1000	1000	1000			
6	1000	1000	1000	1000	1000	1000	500		
8	1000	1000	1000	1000	1000	1000	500	500	
10			1000	1000	1000	1000	500	500	500
12			1000	1000	1000	1000	500	500	500
14			1000	1000	1000	1000	500	500	500
15			1000	1000	1000	1000	500	500	500
16			1000	1000	1000	1000	500	500	500
18			1000	1000	1000	1000	500	500	200
20			1000	1000	1000	1000	500	500	200
25			1000	1000	500	500	500	200	200
30			1000	1000	500	500	200	200	200
35				500	500	500	200	200	200
40				500	500	500	200	200	100

## ● Material · plating

Stainless Steel A2

pcs / Box

L \ d	M3	M4	M5	M6
3	1000			
4	1000	1000		
5	1000	1000	500	
6	1000	1000	500	500
8	1000	1000	500	500
10		1000	500	500
12		1000		500
15		1000		

# HEX SOCKET SET SCREW DOG POINT ISO 4028 / JIS B1177 / DIN 915

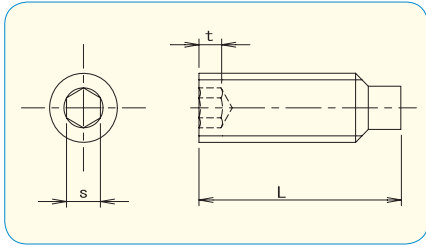

- **Material · plating**  
Steel 45H / Zinc 3Cr. Plated



	M5	M6
s	2.5	3
t	3	3.5

SOCKET  
SCREWS

pcs / Box

L \ d	M5	M6
8	1000	
25		500

# HEX SOCKET CAP SCREW WITH FLANGE

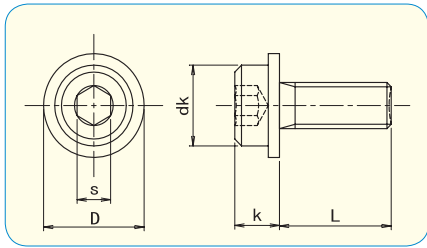

	M3	M4	M5	M6	M8	M10	M12
dk	5.5	7	8.5	10	13	16	18
k	3	4	5	6	8	10	12
s	2.5	3	4	5	6	8	10
D	7.5	9	11	12.5	17	21	24



SOCKET  
SCREWS

## ●Material · plating

Steel 10.9 / Zinc 3Cr. Plated

Steel 10.9 / Zinc Black 3Cr. Plated

pcs / Box

L \ d	M3	M4	M5	M6	M8	M10	M12
5	1000						
6	1000	1000					
8	1000	1000	500	500			
10	1000	1000	500	400			
12	1000	1000	500	400	200		
14		1000		400			
15		1000	500	400	200	100	
16	1000	1000	500	400	200	100	
18		1000	500	400	200		
20	1000	1000	400	400	200	100	
25		500	400	300	200	100	80
30		500	300	300	100	100	70

## ●Material

Stainless Steel A2

pcs / Box

L \ d	M4	M5	M6	M8
6	100	100		
8	100	100	100	
10	100	100	100	100
12	100	100	100	100
15	100	100	100	100
16	100	100	100	100
20	100	100	100	100
25		100	100	100
30				100

# HEX SOCKET BUTTON HEAD SCREW WITH FLANGE

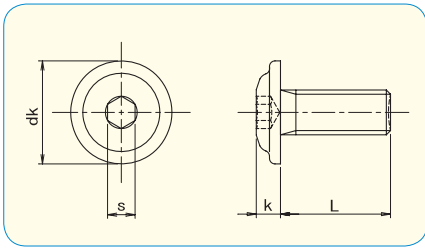

	M3	M4	M5	M6	M8	M10
dk	7	9.2	11.4	13.6	17	20.9
k	1.65	2.2	2.75	3.3	4.4	5.5
s	2	2.5	3	4	5	6



RoHS Directive Compliance

SOCKET SCREWS

## ● Material · plating

Steel 10.9 / Zinc 3Cr. Plated

Steel 10.9 / Zinc Black 3Cr. Plated

pcs / Box

L \ d	M3	M4	M5	M6	M8	M10
6	1,000	1,000				
8	1,000	1,000	1,000	500		
10	1,000	1,000	1,000	500	200	
12	1,000	1,000	1,000	500	200	
15	1,000	1,000	500	500	200	
16	1,000	1,000	500	500	200	200
20	1,000	1,000	500	500	200	200
25		1,000	500	500	200	100
30			500	500	200	100

## ● Material

Stainless Steel A2

pcs / Box

L \ d	M3	M4	M5	M6
6	1,000	200		
8	1,000	200	200	50
10		200	200	50
12		200	200	50
15		200	200	50
16		200	200	50
20		200	200	50
25		200	200	50
30				50



# HEX SOCKET CAP SCREW WITH FLAT WASHER

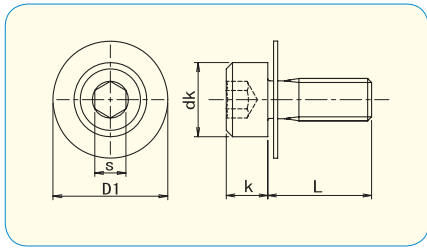

	M3	M4	M5	M6
dk	5.5	7	8.5	10
k	3	4	5	6
s	2.5	3	4	5
D1	8	10	12	13

## ● Material · plating

Steel 10.9 / Zinc 3Cr. Plated

Steel 10.9 / Zinc Black 3Cr. Plated

L \ d	M3	M4	M5	M6
6	1000	1000		
8	1000	1000	500	
10	1000	1000	500	300
12	1000	1000	500	300
16	1000	500	500	300
20	1000	500	300	300
25			300	200
30			200	

## ● Material

Stainless Steel A2

L \ d	M4	M5
8	1000	
10	1000	500
30		200

# HEX SOCKET CAP SCREW WITH SPRING WASHER

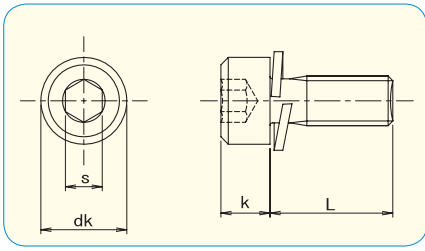

	M3	M4	M5	M6	M8	M10	M12
dk	5.5	7	8.5	10	13	16	18
k	3	4	5	6	8	10	12
s	2.5	3	4	5	6	8	10



RoHS Directive Compliance

SOCKET SCREWS

## Material · plating

Steel 10.9 / Zinc 3Cr. Plated

Steel 10.9 / Zinc Black 3Cr. Plated

		pcs / Box			
L \ d	M3	M4	M5	M6	
5	1000				
6	1000	1000			
8	1000	1000	500	500	
10	1000	1000	500	300	
12	1000	1000	500	300	
14	1000	500	500	300	
15	1000	500	500	300	
16	1000	500	500	300	
18	1000	500	500	300	
20	1000	500	300	300	
25		500	300	200	
30		500	200	200	
35			200	100	
40		500			

## Material

Stainless Steel A2

		pcs / Box						
L \ d	M3	M4	M5	M6	M8	M10	M12	
6	200							
8	200	100	100					
10	200	100	100	50				
12	200	100	100	50				
14		100	100	50				
15	200	100	100	50	50	50		
16	200	100	100	50	50	50		
18		100	100	50				
20		100	100	50	50	50	50	
25		100	100	50	50	50	50	
30		100		50	50	50	50	
35					50	50	50	
40						50	50	
45							50	
50							50	

# HEX SOCKET CAP SCREW WITH SPRING & FLAT WASHER

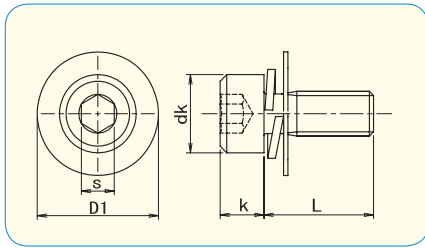

	M2	M3	M4	M5	M6	M8
dk	3.8	5.5	7	8.5	10	13
k	2	3	4	5	6	8
s	1.5	2.5	3	4	5	6
D1	6	8	10	12	13	18

## ●Material · plating

Steel 10.9 / Zinc 3Cr. Plated

Steel 10.9 / Zinc Black 3Cr. Plated

		pcs / Box				
L	d	M2	M3	M4	M5	M6
4		1000				
5			1000			
6			1000	1000		
8			1000	1000	500	
10		1000	1000	1000	500	300
12			1000	1000	500	300
14			1000	500	500	300
15			1000	500	500	300
16			1000	500	500	
18			1000	500	500	
20			1000	500	300	
22			1000	500	300	
25				500	300	
30				500	200	
35				500		
40				500		
45				400		
50				400		

## ●Material

Stainless Steel A2

		pcs / Box				
L	d	M3	M4	M5	M6	M8
4		1000				
5		1000				
6		1000	1000			
8		1000	1000	500		
10		1000	1000	500	300	
12		1000	1000	500	300	100
14		1000	500	500	300	
15		1000	500	500	300	100
16		1000	500	500	300	100
18		1000	500	500	300	100
20		1000	500	300	300	100
22		1000	500	300	300	100
25		1000	500	300	200	100
30		1000	500	200	200	100
35		500	500	200	100	100
40			500	100	100	100
45			400	100	100	100
50			400	100	100	100
55					100	
60					100	
65					100	
70					100	

# HEX SOCKET CAP SCREW WITH SPRING & FLAT WASHER

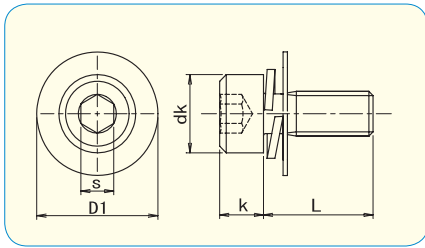

● **Material**  
Stainless Steel A2



	M2	M2.5	M3	M4	M5	M6	M8	M10	M12
dk	3.8	4.5	5.5	7	8.5	10	13	16	18
k	2	2.5	3	4	5	6	8	10	12
s	1.5	2	2.5	3	4	5	6	8	10
D1	5	6.5	7	9	10	12.5	17	21	24



SOCKET  
SCREWS

pcs / Box

L \ d	M2	M2.5	M3	M4	M5	M6	M8	M10	M12
5	200	200	200						
6	200	200	200	100					
8	200	200	200	100	100				
10	200	200	200	100	100	50			
12	200	200	200	100	100	50			
14	200	200	200	100	100	50			
15	200	200	200	100	100	50	50	50	
16	200	200	200	100	100	50	50	50	
18			200	100	100	50	50		
20		200	200	100	100	50	50	50	30
22				100	100	50			
25			200	100	100	50	50	50	30
30			200	100	100	50	50	50	30
35				100	100	50	50	50	30
40			200	100	100	50	50	50	30
45						50	50	50	30
50				100	100	50	50	50	30
55						50			
60						50			
65						50			
70						50			